

DR370-3 Series Radial Leaded Inductors

Features

- High Current Rating
- Height: 10.5mm Max
- Inductance Range: 0.39 μ H – 2.0 μ H
- Non-RoHS Versions are Available (Note 5)



ELECTRICAL SPECIFICATIONS AT 25°C

OPERATING TEMPERATURE -55°C to +125°C

Part Number	Inductance (μ H) 1V @ 100kHz, 0A _{dc}	DCR (m Ω) Max.	Heating Current I _{dc} (Note 3)	Saturating Current I _{dc} (Note 4)
DR370-3-391	0.39	0.75	42	56
DR370-3-471	0.47	0.75	42	56
DR370-3-681	0.68	1.1	38	50
DR370-3-801	0.8	1.1	30	43
DR370-3-102	1.0	1.3	28	28
DR370-3-202	2.0	2.1	20	20

MECHANICAL SPECIFICATIONS

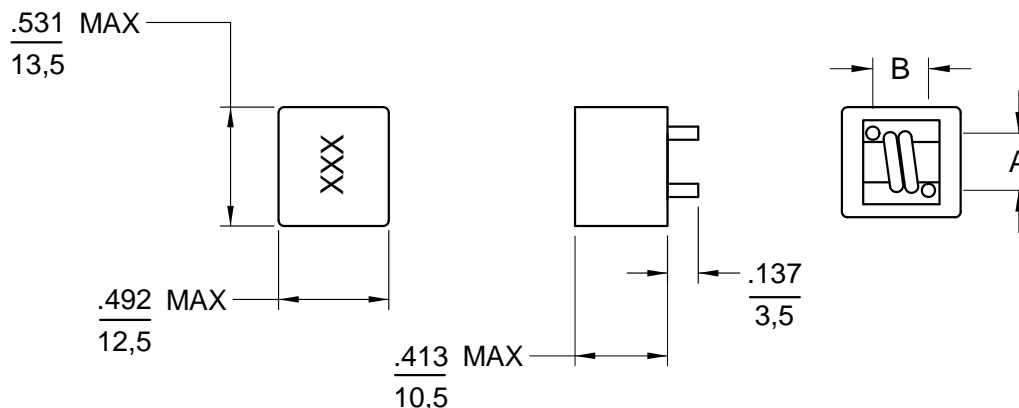

Part Number	Pin Diameter	A	B
DR370-3-391	0.059/1.5	0.327/8.3	0.157/4
DR370-3-471	0.059/1.5	0.327/8.3	0.157/4
DR370-3-681	0.059/1.5	0.327/8.3	0.236/6
DR370-3-801	0.059/1.5	0.327/8.3	0.236/6
DR370-3-102	0.059/1.5	0.327/8.3	0.236/6
DR370-3-202	0.051/1.3	0.327/8.3	0.276/7

Unless otherwise specified,
TOLERANCE: .XXX = 0.020 inches
.X = 0.5 mm

NOTES:

1. Dimensions are shown in inches/millimeters
2. Inductance tolerance: \pm 20%
3. DC current that will cause a rise of 40°C from ambient
4. DC current causing a 30% drop in inductance
5. For non-RoHS parts replace DR prefix with 42- (e.g. DR370-3 becomes 42-370-3)
6. Terminal finish is compliant to RoHS requirements